



INSTRUCTION GUIDE : OE SERIES WHEELS

NEEDED:

Stan's NoTubes ZTR wheel set, 2 tires, Stan's NoTubes Tire Sealant, core remover tool, injector or 2 oz. bottle, floor pump or compressor, soapy water, safety goggles.

IMPORTANT NOTE:

Never inflate any tire without a tube above 40psi unless it is specifically labeled for tubeless use. Maximum pressure listed on your rims may differ from maximum pressure listed on your tires. Do not inflate above the lower of the two numbers.

WARNING:

Always wear safety goggles, Sealant can stain clothes or furniture.

1

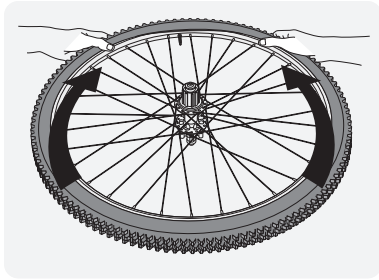

Mount tire: Making sure to position the tire bead in the center channel of the rim, mount one tire bead beginning opposite the valve and finishing at the valve. Once the first bead is mounted begin mounting the second bead opposite the valve and finish at the valve.

2

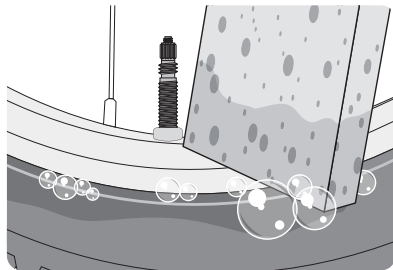

With a brush or sponge apply a generous amount of soapy water to both beads of the tire to help it slip onto the bead of the rim when inflating.

3

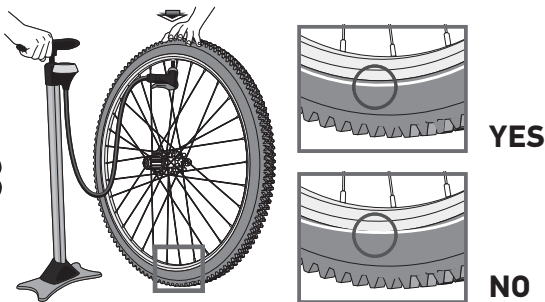

Rotate the valve to 12 o'clock and install a pump. Inflate tire to 35psi to seat tire.

4

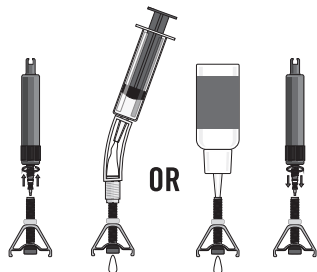

Add sealant: Once successful with inflation remove the valve core to add Stan's sealant. Add 2-4 oz. of sealant.

5

Inflate to preferred riding pressure. Always review the maximum pressure information listed on both the rim and the tire and consider the lower of the two numbers your maximum pressure. Do not inflate above the lower of the two numbers.

6

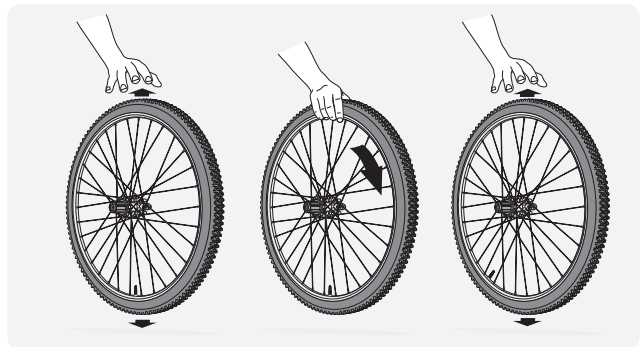

Bounce: hold the wheel vertically and gently bounce or "dribble" it to disperse the sealant throughout the inside of the tire. Let it drop from an inch or two, then rotate a few degrees and repeat. Do this for several revolutions of the wheel.

7

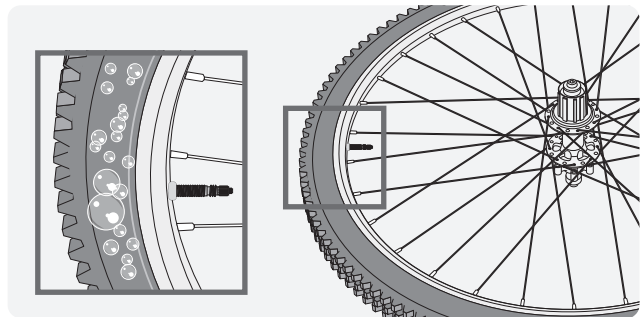

Lay tire on side and apply a thin sheen of soapy water around the sidewall and the bead area. Look for suds occurring anywhere on the tire or bead area. Suds bubbling out from the tire indicate porous areas. Shake the sealant to those areas to seal them and apply soap and water again. Check for suds forming on both sides of the tire. Repeat until no suds remain. Install the cassette and rotors according to the component manufacturer's recommendations.

STAN'S NOTUBES OE SERIES ALUMINUM RIM SETUP GUIDE



RIMS	WEIGHT 20/24/26/27.5/29	ERD 20/24/26/27.5/29	MAX SPOKE TENSION (KgF)	STAN'S BUILD TENSION (KgF)	TAPE WIDTH	VALVE
Crest S1	NA/NA/388/406/433g	NA/NA/541/566/604	125	125	25mm	35mm
Arch S1	NA/NA/452/472/504g	NA/NA/541/566/604	125	125	27mm	35mm
Flow S1	NA/NA/524/548/584g	NA/NA/541/566/604	125	125	30mm	35mm
Sentry S1	NA/NA/524/548/584g	NA/NA/539/564/602	125	125	33mm	35mm
Baron S1	NA/NA/537/561/598g	NA/NA/539/564/602	125	125	36mm	35mm
Major S1	NA/NA/553/578/616g	NA/NA/539/564/602	125	125	39mm	35mm
Grail S1	NA/NA/NA/NA/490g	NA/NA/NA/NA/590	125	125	25mm*	44mm
Crest D	319/400/NA/458/488g	388/489/NA/566/604	125	125	25mm	35mm
Arch D	365/458/NA/524/559g	388/489/NA/565/604	125	125	27mm	35mm
Flow D	NA/NA/NA/594/634g	NA/NA/NA/566/604	125	125	30mm	35mm

*REQUIRES TWO LAYERS OF TAPE

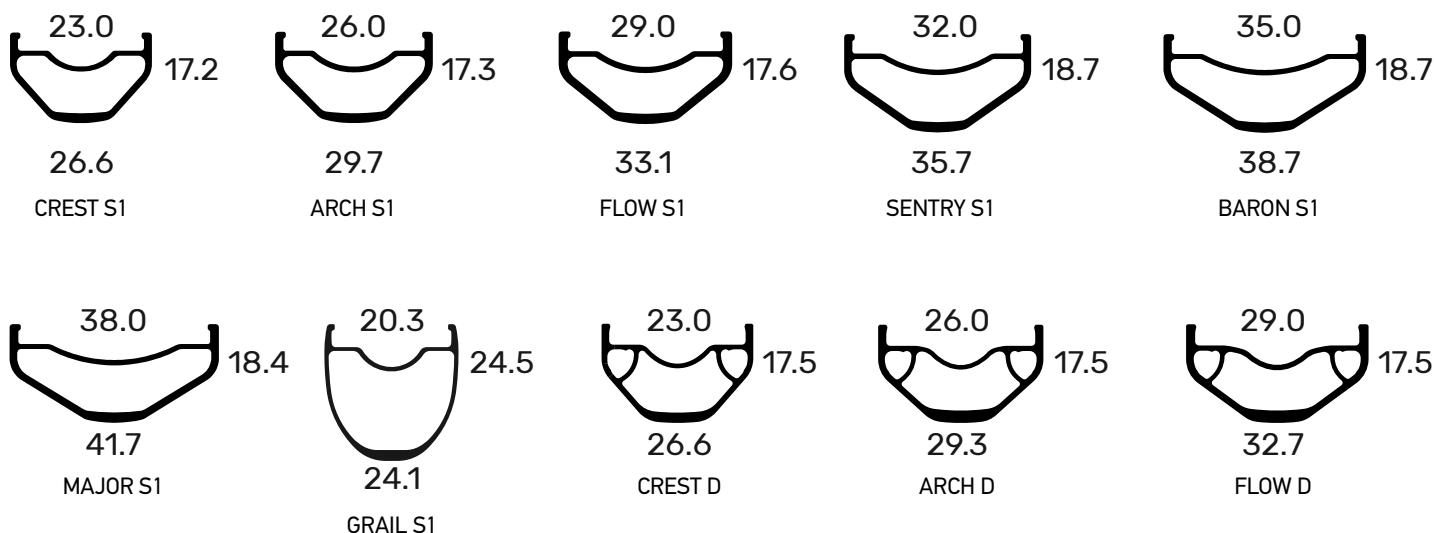

NOTE: ALL RIMS ARE DESIGNED FOR DISC BRAKE USE ONLY

Caution: Stan's rims are optimized for tubeless use and designed to set up tubeless with Stan's Yellow Tape, Universal Valves, and Tire Sealant. Tubes may also be used on all Stan's rims; as with all tube installations, care must be taken to prevent tubes from being caught underneath the bead of the tire, causing the tire to dismount when inflated.

Rim Tape: Stan's NoTubes Yellow Rim Tape is designed for use with all Stan's rims. Use of other tapes is not recommended. BST rims require one layer of Yellow Tape; BST-R rims require two layers. See above chart for tape width. Tape installation and additional how-to videos are available at: <https://www.notubes.com/help>

Tubeless Setup: Important: Never inflate any tire without a tube above 40psi unless it is specifically labeled for tubeless use. Maximum pressure listed on your rims may differ from maximum pressure listed on your tires. Do not inflate above the lower of the two numbers.

Warranty: Warranty policies for aluminum rims can be found at: <https://www.notubes.com/warranty-info>